

# ***TC37 & TC39 Tire Changers***

***Easy-to-use center-clamp tire changers***



# Key features at a glance



## STANDARD

### Bead press arm

- ✓ Assists mounting difficult assemblies

## Two mount head options

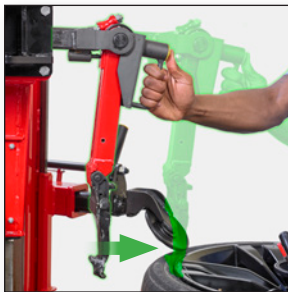

## PATENTED TC39

### Leverless

- ✓ Positions bead without levers
- ✓ Prevents damage to tire and rim
- ✓ Quick and easy

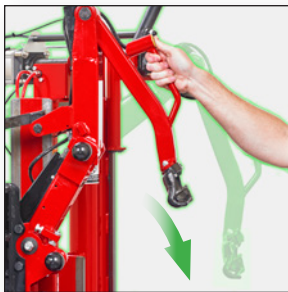

## TC37

### Traditional

- ✓ Polymer construction prevents damage to tire and rim
- ✓ Vertical locking head protects wheel face



### Motor and drive

- ✓ 0-14 rpm variable clockwise speed, 7 rpm counter-clockwise speed
- ✓ 867 ft-lbs. of torque



### Blast inflation

- ✓ Directs bursts of compressed air to easily seat the bead





## Single pendant control

- ✓ Simple intuitive operation
- ✓ All controls at fingertips



### EXCLUSIVE

## Split bead roller system

- ✓ Direct indentation speeds bead-breaking on all tires
- ✓ Quickly demount bottom bead with lower roller
- ✓ Match-mounting made easy

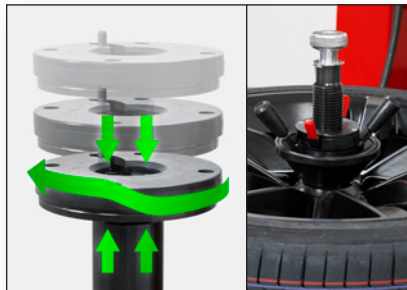

### PATENTED

## Center-clamp system

- ✓ Simple clamping technique
- ✓ Cam action multiplies clamping force
- ✓ Three height positions



### OPTIONAL

## PowerOut™ bead loosener

Ergonomic control handle makes operation easy

Wheel protection sleeve included

## Match-mounting & bead massage made easy



Hunter's center-clamp tire changers and Road Force® wheel balancers:

- ✓ Eliminate vibration problems
- ✓ Reduce comebacks
- ✓ Increase customer satisfaction

*The bead rollers safely hold the tire stationary while the rim is rotated to complete match-mounting.*



# Specifications

<b>Rotation speed</b>	0-14 clockwise 7 counter-clockwise
<b>Torque</b>	867 ft.-lbs.
<b>Electrical requirements</b>	220V, 1 ph, 6 A
<b>Air pressure operating range</b>	115-175 psi
<b>Rim diameter range</b>	10-26 in.
<b>Max. tire diameter</b>	46 in.
<b>Max. bead roller opening width</b>	15 in.
<b>Side shovel (optional)</b>	
Max. bead-loosening opening width	15 in.
Shovel power	6,600 lbs. @ 140 psi

\* Some dimensions, capacities and specifications may vary depending on tire and wheel configurations.



TC37 shown

## Models

	TC39SSW	TC39W	TC39SS	TC39	TC37SSW	TC37W	TC37SS	TC37
Leverless mount head	✓	✓	✓	✓				
Traditional mount head					✓	✓	✓	✓
PowerOut™ bead loosener	✓		✓		✓		✓	
Wheel lift	✓	✓			✓	✓		

## Optional accessories



### Flange plate for chrome-clad and reverse wheels RP6-G1000A87

Useful for chrome-clad wheels and/or reverse wheels where maximum finish protection is needed.



### Flange plate for chrome-clad wheels RP6-G1000A123

Simplified flange plate for chrome-clad wheels only.

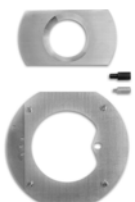

### 19.5" adaptor 20-2341-1

Adapts large center-bore wheels to center-clamp tire changers.



### Wheel lift package 20-3442-1

Optional wheel lift eases servicing of large assemblies. Allows for more careful handling of expensive wheels.



### PowerOut™ bead loosener 20-3443-1

Offers powerful traditional bead-breaking

*Be sure to check out other literature for more quality products from Hunter Engineering.*



# HUNTER

Engineering Company

[www.hunter.com](http://www.hunter.com)